

**AMENDMENT #10 TO AGREEMENT BETWEEN OWNER AND DESIGN  
PROFESSIONAL  
FOR DESIGN AND CONSTRUCTION ADMINISTRATION SERVICES  
PINE VIEW HVAC AND INTERIOR RENOVATION**

THIS AMENDMENT #10 to Agreement Between Owner and Design Professional for Design and Construction Administration Services is entered into this **5<sup>th</sup> day of September, 2017**, by and between The School Board of Sarasota County, Florida, a body corporate under the laws of the State of Florida (the "Owner") and Seibert Architects PA (the "Design Professional").

**R E C I T A L S**

A. The Owner and the Design Professional entered into an Agreement Between Owner and Design Professional for Design and Construction Administration Services for the **Pine View HVAC and Interior Renovation Project** (the "Agreement"), dated **September 2, 2014**.

B. The parties hereto desire to modify the Agreement, and hereby enter into this Amendment #10 to memorialize this modification.

NOW, THEREFORE, in consideration of the mutual promises made herein, the parties do hereby agree as follows:

1. The Agreement amount is hereby modified to include fees for all services included in this agreement. The total fee amount of this Agreement is **\$1,255.060.20**.

2. Exhibits "A" and "B" dated **September 5, 2017**, attached to this Amendment #10, shall replace those originally issued with the Agreement. Exhibit "C" Seibert Architects Proposal is also attached to this **Amendment #10**.

3. The parties acknowledge and agree that, except as otherwise expressly modified or amended herein, the remainder of the terms of the Agreement shall remain

in full force and effect.

4. Where there is any conflict between the terms of this Amendment #10 and any terms of the Agreement, the terms of this Amendment #10 shall control.

IN WITNESS WHEREOF, the parties have executed this Amendment #10 as of the date first above written.

THE SCHOOL BOARD OF SARASOTA  
COUNTY, FLORIDA

SEIBERT ARCHITECTS PA

BY: \_\_\_\_\_  
Caroline Zucker, Board Chair

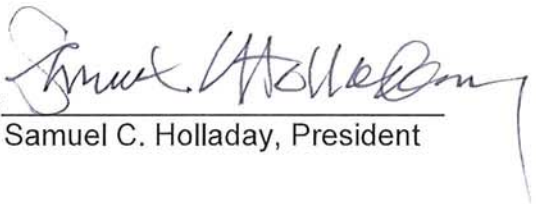
BY:   
Samuel C. Holladay, President

Approved for Legal Content  
May 2014 by Matthews, Eastmoore,  
Hardy, Crauwels & Garcia, Attorneys for  
The School Board of Sarasota County, Florida  
Signed: MG

**EXHIBIT "A"**  
**INVOICE FOR PROFESSIONAL SERVICES (REVISED 9/5/2017)**

TO: The School Board of Sarasota County, Florida  
 Construction Services Department  
 7895 Fruitville Road  
 Sarasota, FL 34240

ATTN: Sue Bouffard , Project Manager

DESIGN PROFESSIONAL: Seibert Architects PA  
1373 Fifth Street  
Sarasota, FL 34236

INVOICE NO.: \_\_\_\_\_  
 DATE: \_\_\_\_\_

Sarasota County Schools Project Name: Pine View School - HVAC and Interior Renovation

Sarasota County Schools Project No.: 3021 Sarasota County Schools Contract No. 21502588

Professional Project No.: \_\_\_\_\_

SERVICE	SCHEDULED VALUE	% COMPLETE	TOTAL PREVIOUS PAYMENTS +	PAYMENT REQUEST THIS INVOICE =	TOTAL AMOUNT DUE TO DATE
Schematic Design Phase 15%	\$ 144,750.00	0.00%			\$ -
Design Development Phase 15%	\$ 144,750.00	0.00%			\$ -
Construction Document Phase 30%	\$ 289,500.00	0.00%			\$ -
Bidding/Negotiation Phase 5%	\$ 48,250.00	0.00%			\$ -
Construction Administration Phase 30%	\$ 289,500.00	0.00%			\$ -
Final Acceptance 5%	\$ 48,250.00	0.00%			\$ -
Total Fee 100%	\$ 965,000.00	0.00%	\$ -	\$ -	\$ -
Total Add'l Services	\$ 290,060.20	0.00%	\$ -	\$ -	\$ -
Total Reimbursables	\$ -	#DIV/0!	\$ -	\$ -	\$ -
Grand Total	\$ 1,255,060.20	0.00%	\$ -	\$ -	\$ -

TOTAL AMOUNT DUE AND PAYABLE THIS INVOICE: \$ -

CERTIFIED TRUE AND CORRECT BY: *Sandra C. Howard* 8/10/17  
 (Signature of Design Professional) (Date)  
 Typed Name and Title: Sandra C. Howard , PRESIDENT

(For Sarasota County Schools Use ONLY)

Recommended for Payment by: \_\_\_\_\_  
 (Signature of Project Manager) (Date)

**PROFESSIONAL SERVICES INVOICE FOR AMENDMENTS / ADDITIONAL SERVICES**

AMENDMENT # / ADD. SERVICES DESCRIPTION)	(INCLUDE	SCHEDULED VALUE (BUDGET)	% COMP	TOTAL PREVIOUS PAYMENTS +	PAYMENT REQUEST THIS INVOICE =	TOTAL AMOUNT DUE TO DATE
B1.1-SWFWMD Design & Permitting		\$ 6,000.00	0%			\$ -
B1.5-FDEP Design & Permitting		\$ 4,000.00	0%			\$ -
B1.6-Sanitary Sewer System		\$ 4,000.00	0%			\$ -
B1.8 Building 6 Security Remodel		\$ 30,806.00	0%			\$ -
B1.9 Ceilings at Locker Building Locker Pods		\$ 4,320.00	0%			\$ -
B1.10 Fire Alarm System Design		\$ 15,693.00	0%			\$ -
B1.11 Building 5 Tankless Water Heaters		\$ 4,176.20	0%			\$ -
B1.12 Rework Classroom Building Gable Ends		\$ 4,800.00	0%			\$ -
B1.13 Design Security Cameras@ Shell Lot		\$ 990.00	0%			\$ -
B1.14 B-6 Temp Office & Clinic Portables		\$ 1,840.00	0%			\$ -
B1.15 B-6 Technology Revisions @ B-6		\$ 24,260.00	0%			\$ -
B1.16 Decorative and Chain Link Security Fencing		\$ 24,715.00	0%			\$ -
B1.17 Clinic Design		\$ 4,600.00	0%			\$ -
B1.18 Portables at North Side of Campus		\$ 32,045.00	0%			\$ -
B1.19 Kitchen Hood Fans		\$ 5,885.00	0%			\$ -
B1.20 Ext Path Lighting, Golf Cart Charging and Lighting and Upgrades to Auditorium		\$ 14,345.00	0%			
B1.21 Modular Band Practice Room		\$ 1,450.00	0%			
B1.22 Building 11 Science Classroom Upgrades		\$ 106,135.00	0%			
			#DIV/0!			\$ -
<b>TOTAL AMENDMENTS/ADD'L SERVICES</b>		<b>\$ 290,060.20</b>	<b>0%</b>	<b>\$ -</b>	<b>\$ -</b>	<b>\$ -</b>

ATTACH DOCUMENTATION TO SUPPORT ADDITIONAL SERVICES ITEMS.

CERTIFIED TRUE AND CORRECT BY:

  
 (Signature of Design Professional)

8.18.17  
 (Date)

Typed Name and Title: SAMUEL C HOLIDAY PRESIDENT

(For Sarasota County Schools Use ONLY)

Recommended for Payment by: \_\_\_\_\_  
(Signature of Project Manager) (Date)

**PROFESSIONAL SERVICES INVOICE FOR REIMBURSABLES**

REIMBURSABLES (INCLUDE DESCRIPTION)	SCHEDULED VALUE (BUDGET)	% COMP	TOTAL PREVIOUS PAYMENTS +	PAYMENT REQUEST THIS INVOICE =	TOTAL AMOUNT DUE TO DATE
		#DIV/0!			\$ -
		#DIV/0!			\$ -
		#DIV/0!			\$ -
		#DIV/0!			\$ -
		#DIV/0!			\$ -
		#DIV/0!			\$ -
		#DIV/0!			\$ -
		#DIV/0!			\$ -
		#DIV/0!			\$ -
		#DIV/0!			\$ -
		#DIV/0!			\$ -
		#DIV/0!			\$ -
		#DIV/0!			\$ -
		#DIV/0!			\$ -
		#DIV/0!			\$ -
		#DIV/0!			\$ -
		#DIV/0!			\$ -
<b>TOTAL REIMBURSABLES</b>	\$ -	#DIV/0!	\$ -	\$ -	\$ -

INSERT THESE FIGURES ON FORM A ON THE LINE FOR TOTAL REIMBURSABLES.  
ATTACH DOCUMENTATION TO SUPPORT REIMBURSABLE ITEMS.

CERTIFIED TRUE AND CORRECT BY:  8.18.17  
 (Signature of Design Professional) (Date)  
 Typed Name and Title: SAMUEL G. HOURDARY PRESIDENT

(For Sarasota County Schools Use ONLY)  
 Recommended for Payment by: \_\_\_\_\_ (Date)  
 (Signature of Project Manager)

**EXHIBIT "B"**  
**SCHEDULE OF ADDITIONAL SERVICES (REVISED 6/6/2017)**

**B.1 ADDITIONAL SERVICES**

**B.1.1** On-site surface water management and drainage conceptual studies with professional guidance, reports, recommendations, biologist studies of wet areas, water retention design, filing of applications for administrative permits and for approvals of The Southwest Florida Water Management District (SWFWMD) and the Florida Department of Environmental Protection as required for development of the proposed project shall not exceed \$6,000.00.

**B.1.2** Off-site Surface Water Management and Drainage Conceptual Studies with professional guidance, reports, recommendations, biologist studies of wet areas, water retention design, filing of applications for administrative permits and for approvals of The Southwest Florida Water Management District (SWFWMD) and the Florida Department of Environmental Protection as required for development of the proposed project shall not exceed \$ N/A.

**B.1.3** Traffic impact studies, reports, recommendations and professional guidance performed by professionally trained consultants, traffic light request applications, as required by the public agencies having jurisdiction of the Project, for the purpose of preparing suggestions and recommendations for appropriate traffic circulation, ingress and egress to and from the site for off site roadways providing of professional services for the filing of applications for administrative permits and securing approvals for traffic concepts to be utilized in developing the Master Plan for proposed development of the property. Compensation for professional services shall not exceed:

**B1.3.1:** \$ N/A for study and report.

**B1.3.2:** \$ N/A for design and construction documents to implement governmental agency requests.

**B1.3.3:** \$ N/A for professional services related to the design and/or construction of roadways, pavement or traffic improvements off-site.

**B.1.4** Professional Services to coordinate, and filing of applications for permits and approvals, furnish design, construction documents, and construction administration for the installation of water supply and sewer for off-site utilities, shall not exceed \$ N/A.

**B.1.5** Professional Services to coordinate, filing of applications for permits and approvals, furnish design, construction documents, and construction administration for areas regulated by the Florida Department of Environmental Protection for project development shall not exceed \$ 4,000.00.

**B.1.6** Professional Services for full time inspection of sanitary sewer facilities designed by the Civil Engineer who shall be responsible for the completion of record drawings of all improvements required for certification to the appropriate governmental agencies shall not exceed \$ 4,000.00.

**B.1.7** Professional Services to coordinate filing of applications for Rezoning, Special Exceptions and furnishing information for approvals to Governmental Agencies regulating project site development shall not exceed \$ N/A.

**B.1.8** Design for the Administration Building 6, security remodel shall not exceed \$30,806.00

- B.1.9** Design for the addition of ceilings at the classroom building locker pods, shall not exceed \$4,320.00
- B.1.10** Design of revisions to the existing fire alarm system, shall not exceed \$15,693.00.
- B.1.11** Design power and plumbing required to repace existing water heaters in Building 5 with tankless water heaters, shall not exceed \$4,176.20.
- B.1.12** Rework the gable ends of the classroom buildings, in accordance with recommendations provided by the Owner's building envelope consultant, shall not exceed \$4,800.00.
- B1.13** Provide the technology design to replace the required cabling to both parking lot lighting poles each with four security cameras, shall not exceed \$990.00.
- B1.14** Provide the engineering and technology design for the temporary Administration Offices and Clinic portables, shall not exceed \$1,840.00.
- B1.15** Provide the architectural, engineering and technology design to relocate the majority of the equipment in IDF Room 621A in the Administration Building's Workroom to new technology cabinets along the south wall to provide visual access to both the new entry to the building on the east side and the existing entry on the west side of the building, including new cabinetry. All structured cabling in Building 6 will be replaced with CAT6 cabling. A new fiber rack will be added to the existing MDF in Rooms 912 & 912A in Building 9 to house a VoIP phone system to be installed by Owner. A 25 pair copper cable will be run from the existing Verizon Demarc from Building 13 to the MDF in Building 9. The cost of this work shall not exceed \$24,260.00.
- B1.16** Provide architectural and engineering design for campus decorative and chain link security fencing. The cost of this work shall not exceed \$24,715.00.
- B1.17** Provide design and construction administration services for the renovations to the Clinic area of Building #6. The cost of the work shall not exceed \$4,600.00.
- B1.18** Provide design and construction administration services for the twelve portables to be added to the north side of campus and the relocation of eight portables on the south side of campus. The cost of the work shall not exceed \$32,045.00.
- B1.19** Provide design and construction administration services for the replacement of the kitchen hood fans. The cost of this work shall not exceed \$5,885.00.
- B1.20** Provide design and construction administration services for the exterior pathway lighting at the Administration Building #6, golf cart charging station power and canopy lighting, replacement of Auditorium Building #8 seating and house lighting and controls. The cost of this work shall not exceed \$14,345.00.
- B1.21** Provide design and construction administration services for a new modular band practice room to be installed in Room 811 and in accordance with RFI #36. The cost of this work shall not exceed \$1,450.00.
- B1.22** Provide design and construction administration services for the re-design of the Building 11 Science Classrooms including relocation of walls and upgrades to the existing interior of the building. The cost of this work shall not exceed \$106,135.00.



## B.2 SCOPE OF SERVICES EXCLUSIONS

- See attached Exhibit "C"

## B.3 HOURLY RATES

Seibert Architects, P.A. (Architect)		
Principal Architect	\$150.00	per hour
Project Architect	\$130.00	per hour
Staff Architect	\$115.00	per hour
Draftsman I	\$105.00	per hour
Interior Designer, Registered	\$130.00	per hour
Interior Design, Staff	\$ 95.00	per hour
Clerical	\$ 40.00	per hour
ME3 Consulting Engineers, LLC (MEP)		
Principal	\$145.00	per hour
Sr. Engineer	\$130.00	per hour
Staff Engineer	\$115.00	per hour
Designer	\$ 70.00	per hour
Clerical	\$ 55.00	per hour
Fire Protection		
Professional Fire Protection Engineer (FP)	\$130.00	per hour
Engineering Technician (NICET Certified) (FP)	\$115.00	per hour
Cad Drafting Technician (FP)	\$ 70.00	per hour
Administration (FP)	\$ 55.00	per hour
Hees & Associates, Inc. (Structural Engineer)		
Principal Engineer	\$120.00	per hour
Threshold Inspector	\$120.00	per hour
Licensed Engineer-Project Engineer	\$ 95.00	per hour
Engineering Intern-Staff Engineer	\$ 75.00	per hour
Threshold Inspector Representative	\$ 75.00	per hour
Construction Administrator	\$ 65.00	per hour
CADD Designer	\$ 60.00	per hour
Clerical	\$ 40.00	per hour
Jensen & Group Engineering Consultants (Civil)		
Principal	\$155.00	per hour
Sr. Project Manager	\$125.00	per hour
Project Manager	\$110.00	per hour
Senior Engineer	\$110.00	per hour
Project Engineer	\$ 90.00	per hour
Construction Manager	\$ 90.00	per hour
Design Engineer	\$ 80.00	per hour
Designer	\$ 85.00	per hour
CADD Technician	\$ 50.00	per hour
Construction Representative	\$ 65.00	per hour
Secretary	\$ 55.00	per hour

David W. Johnston Associates, Inc. (Landscape)		
Project Manager, Senior	\$150.00	per hour
Project Manager, General	\$125.00	per hour
Landscape Architect, Senior	\$135.00	per hour
Landscape Architect, General	\$115.00	per hour
Expert Witness/Hearing Testimony	\$160.00	per hour
Designer, Landscape	\$100.00	per hour
Designer, Graphic	\$ 90.00	per hour
CADD Technician, Senior	\$ 95.00	per hour
CADD Technician, General	\$ 85.00	per hour
Certified Arborist	\$110.00	per hour
Administrative/Clerical	\$ 55.00	per hour

Callaway Design Group (Technology)		
RCDD Telcom Designer	\$115.00	per hour
CRS-D AV Designer	\$125.00	per hour
Security Designer	\$100.00	per hour
JR Designer	\$ 85.00	per hour
Construction Administration	\$ 80.00	per hour
CAD Operator	\$ 70.00	per hour
Administration/Clerical	\$ 50.00	per hour

## EXHIBIT "C"

seibert architects



August 16, 2017

ADDITIONAL SERVICES PROPOSAL FOR DESIGN AND CONSTRUCTION ADMINISTRATION SERVICES FOR REMODELING BUILDING 11 AS PART OF THE WORK INCLUDED UNDER THE ORIGINAL AGREEMENT, AS AMENDED.

### **General:**

The overall intent is to remodel the existing building 11 science building containing 4 Science Labs and 4 Science Demonstration Rooms of different sizes and other spaces, so that it contains 8 spaces useable as Science Labs and certain other ancillary spaces. The Conceptual design for this has been established through discussions and design review meetings with School District staff, Pine View staff members and other stake holders. This has resulted in a proposed floor plan which has been approved by the stakeholders.

### **Design services to include:**

Attendance at meetings required to discuss the details of the proposed changes and the construction of the changes to building 11.

Revisions to drawings and specifications required to add the remodeling of building 11 to the construction work already under contract. The drawings and specifications will be revised to include the demolition and new construction work required to remodel building 11 to be consistent with the approved floor plan, attached.

In addition to Architectural services, the services provided include modifications to the building's structure, extensive modifications to the Electrical and Plumbing systems, Revisions to Mechanical work and Fire Alarm system revisions.

This proposal does not anticipate the need for revisions to Civil Drawings.

### **Construction Administration services to include:**

Processing and reviewing submittals.

Answering questions and RFIs pertaining to the requirements of the contract documents.

Reviewing the work in progress and at completion to verify substantial compliance with the Construction documents.

Preparation and submittal of record documents based on the contractor's mark-ups.

1373 5th Street ▪ Sarasota, FL  
34236-4915 ▪ seibertarchitects.com  
T 941.366.9161 ▪ F 941.365.0902  
Lic AA-C000070

**architecture • planning • interiors**

Attendance at construction meetings during the extended timeline resulting from this additional work.

**Exclusions and Qualifications:**

Services shall be limited to tasks outlined in this proposal.

No remodeling to the building's exterior envelope or work outside of the building is included in this proposal.

Engineering of systems consistent with those used throughout the existing campus is included. Other systems such as Photovoltaic systems, lightning protection, emergency power, thermal energy storage, rain harvesting, etc. are not included. Refer to attached "Exhibit 'A' – Scope of Services Line Item Summary" provided by ME3 for a more complete listing of items included and not included in the services that they are to provide as part of these additional services.

**Payment:**

Professional fees for the services outlined above total \$106,135.00 including the services provided by Hees & Associates, ME3, and Hatcher Engineering. These services are to be provided as an amendment to our original Agreement dated September 2, 2014. Once the amendment is approved, the terms and conditions of that original agreement will apply equally to the work outlined in this proposal.

The breakdown of the fee for this work is estimated to be as follows:

**Seibert Architects**

Principal Architect	6 hours @ \$150/hr = \$900
Project Architect	214 hours @ 130/hr = \$27, 820
Draftsman	255 hours @ 105/hr = \$26,775

**ME3**

Principal Engineer	4 hours @ 145/hr = \$580
Senior Engineer	180 hours @ 130/hr = \$23,400
Staff Engineer	12 hours @ 115/hr = \$1,380
Designer	15 hours @ 70/hr = \$1,050
Clerical	4 hours @ 55/hr = \$220
Fire Protection Engineer	3 hours @ 130/hr = \$390
Engineering Technician	6 hours @115/hr = 690
Drafting Technician	9 hours @ 70/hr = 630

Hees & Associates

Principal Engineer	11 hours @ 120/hr = \$1,320
Project Engineer	168 hours @ 95/hr = \$15,960
CADD Designer	69 hours @ 60/hr = \$4,140
Clerical	

**EXHIBIT 'A' - SCOPE OF SERVICES LINE ITEM SUMMARY**

<b><u>DESIGN ITEM</u></b>	<b><u>INCLUDED IN SCOPE</u></b>	<b><u>NOT INCLUDED IN SCOPE</u></b>
<b>MECHANICAL – HVAC</b>		
1. Load Calculations	X	
2. Selection of equipment	X	
3. Ductwork	X	
4. Ventilation and Exhaust Systems	X	
5. Hydronic Piping	X	
6. Thermal Energy Storage		X
7. Lab Fume Hood Ducting	X	
8. System Controls	X	
9. Energy Recovery Unit (ERV)		X
10. Condensate Drain	X	
11. Smoke Control for Atrium		X
12. Florida Energy Form	X	
<b>MECHANICAL – PLUMBING</b>		
1. Potable water	X	
2. Sanitary Waste	X	
3. Water Pressure Booster		X
4. Hot Water	X	
5. Hot Water recirculation	X	
6. Grease Interceptor		X
7. Sand / Oil Interceptor		X
8. Chemical Neutralization (under sink model)	X	
9. Gas (Limited to within the building.)	X	
10. Roof Drainage (gutters and downspouts excluded)		X
11. Compressed Air	X	
12. Solar Hot Water		X
13. Rain Harvest system		X
14. Elevator sump pump		X
<b>ELECTRICAL</b>		
1. Coordination of power requirements with utility and Service Entrance		X
2. Site Lighting		X
3. Landscape Lighting (power only)		X
4. Site Photometrics		X
5. Interior Building Power	X	
6. Coordination of power systems for owner selected equipment	X	

<b>DESIGN ITEM</b>	<b>INCLUDED IN SCOPE</b>	<b>NOT INCLUDED IN SCOPE</b>
<b><u>ELECTRICAL continued</u></b>		
7. Building interior lighting	X	
8. Lighting controls	X	
9. Specialized architectural lighting		X
10. Emergency lighting (battery pack) (in fixtures)	X	
11. Emergency power / generator		X
12. Fire Alarm (or modification to existing)	X	
13. Telephone (boxes and conduit)		X
14. Data System (boxes and conduit)	X	
15. Lightning protection (air terminals / preventer type)		X
16. Communications system (boxes and conduits only)	X	
17. Public address system		X
18. CATV / Video system (boxes and conduit only)	X	
19. Security system (boxes and conduit only)	X	
20. Power to sanitary lift station		X
21. Power to signage		X
22. Power to elevator		X
23. Photovoltaic design		X
<b><u>FIRE PROTECTION</u></b>		
1. Fire Sprinkler		X
<b><u>BIDDING AND NEGOTIATION</u></b>		
<b><u>BID / NEGOTIATION</u></b>		
1. Attend pre-bid meetings		X
2. Review and respond to bid evaluation		X
3. Review of contractors cost reduction ideas (value engineering)		X
4. Plan revisions to include value engineering		X
<b><u>CONSTRUCTION SERVICES</u></b>		
<b><u>CONSTRUCTION SERVICES</u></b>		
1. Attendance at construction meetings	X	
2. Response to RFI's	X	
3. Preparation of supplemental documents	X	
4. On-site review of compliance with Plans and Specifications	X	
5. Shop drawing review	X	
6. Final punch review	X	
7. Preparation of Record documents (Per contractor as-built drawings)	X	
<b><u>LEED DOCUMENTATION</u></b>		
1. MEP related LEED Documentation and/or Commissioning		X

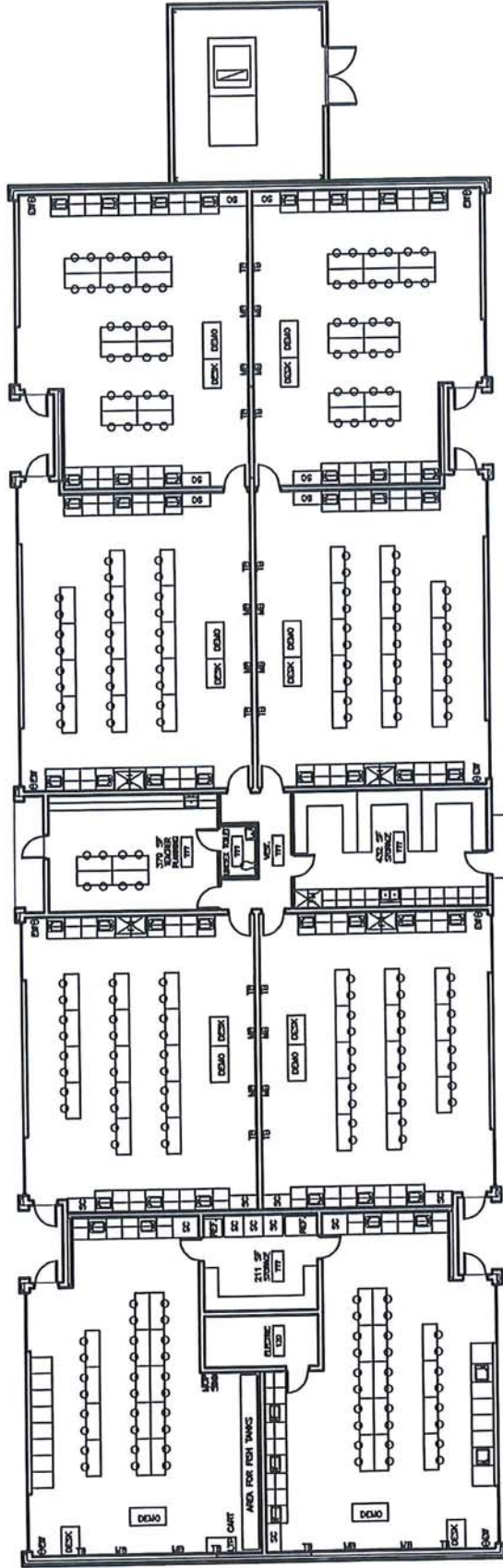

BLDG. 11 - PROPOSED FLOOR PLAN

SCALE: 1/8" = 1'-0"